

MICROFILMED

MAP 2, SEC. 1  
SUGAR CREEK  
S 53-14-36 W  
41.85

N 65-27 W LOT 587

148.07

TRACT 180.53

S 16-20 E

LOT 588

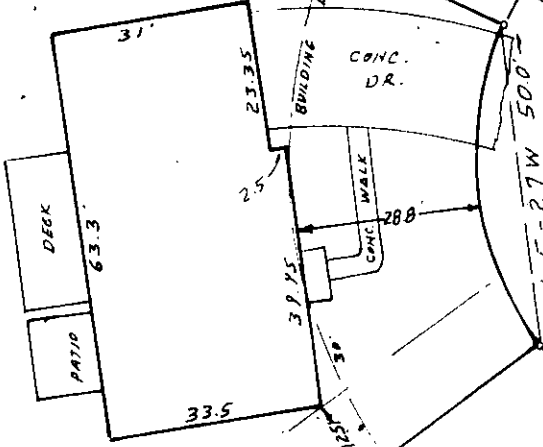

R-50'

SUGARFIELD CT.

R.P. 93 TO  
STONE CREEK RD.

SAN. SEWER EASEMENT  
N 54-33 E

LOT 589

SURVEY FOR  
**WILLIAM A. & KATHLEEN A. DUNN**  
 NEAR GREENVILLE S.C.  
 SCALE 1"=30' JULY 19, 1983

REF: LOT NO. 588 ON PLAT OF SUGAR CREEK,  
 MAP 1, SECTION 3, RECORDED IN PLAT BOOK  
 9F PAGE 35.

NOTE: DRAINAGE & UTILITIES EASEMENT 5'  
 EACH SIDE OF SIDE AND REAR LOT LINES.

FILED  
 GREENVILLE CO. S.C.  
 JUL 22 10 41 AM '83.  
 DONNIE S. STARKERSLEY  
 R.M.C.

I certify that this is an accurate plat of a survey made by me July 19th., 1983, that the structure located on said premises does not encroach or project on adjacent streets or property except as shown hereon, that there are no easements visible on the ground except as noted hereon, and that the structure located on said premises is not in a designated 100 year flood plain.

9-V-60

2560



JUL 22 1983

RIS #1547 Greenville, S.C.

SC10 -- 1 JUL 22 83

3.0001